

**1**  
IDENTIFY CUT MARK ON STRANDS. LOCATED EVERY 2 INCHES ON 12V TAPE (6 IN. FOR HO-24V, 4 IN. FOR VHO-24V)



**2**  
CUT BETWEEN SOLDER CIRCLES ON THE DESIGNATED LINE AS SEEN IN STEP 1.



**3**  
ONCE CUT, THERE ARE 2 OPTIONS FOR WIRE CONNECTION. STEPS 4-6 ARE FOR POWER FEED ADAPTER OR STEPS 7-12 FOR DIRECT SOLDERING.

**ADAPTER OPTION**

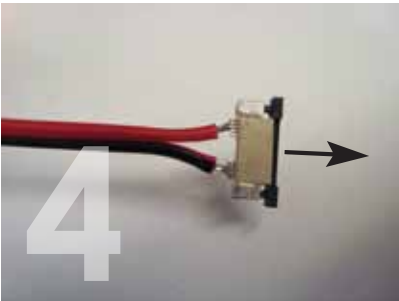

**4**  
WITH POWER FEED ADAPTER, PULL BLACK TAB OUT IN ORDER TO EXPOSE OPENING FOR STRANDS.

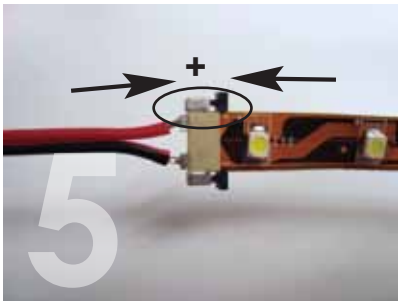

**5**  
PUSH STRANDS INTO ADAPTER OPENING. MAKE SURE POSITIVE HAS RED WIRE, NEGATIVE HAS BLACK WIRE.

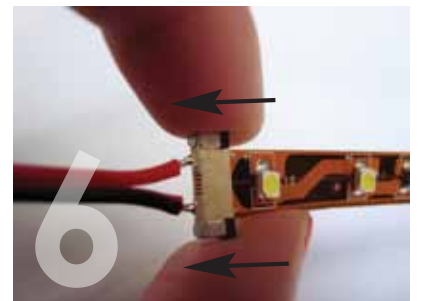

**6**  
LOCK STRANDS INTO PLACE BY SLIDING BLACK FITTING TOWARDS WIRE IN LOCKING POSITION.

**SOLDER OPTION**



**7**  
ALIGN RED WIRE TO POSITIVE SIDE OF CIRCUIT BOARD. SOLDER, THEN REPEAT WITH BLACK WIRE TO NEGATIVE.

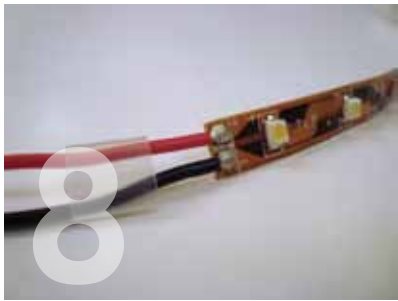

**8**  
MAKE SURE SOLDER CONNECTION APPEARS AS SHOWN. MAKE CERTAIN SOLDER JOINTS DO NOT TOUCH.



**9**  
APPLY PENCIL ERASER SIZE AMOUNT OF CLEAR SILICON ADHESIVE TO PROTECT CONNECTION.

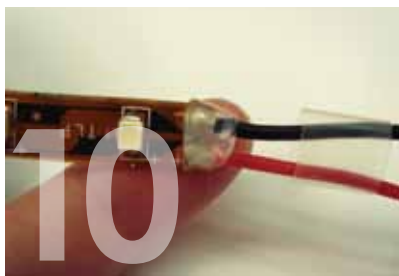

**10**  
FLATTEN WITH FINGER AND SMOOTH OVER FRONT AND BACK OF CONNECTION. SET ASIDE TO DRY.



**11**  
ONCE GLUE SETS, FLIP OVER STRIP TO CUT BACK 1/4" PAPER FROM ADHESIVE NEAR CONNECTION.

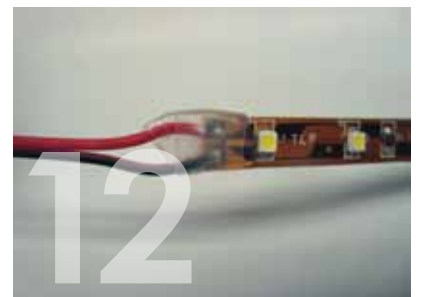

**12**  
SLIDE HEATSHRINK OVER DRIED SILICON AREA. SHRINK UNTIL SNUG.